

These drawings are instruments of service and are the property of Golden Valley Engineering & Surveying, Inc. They are to be used only for the project and site for which they were prepared and no part of them shall be reproduced or transmitted in any form or by any means, electronic, mechanical, photocopying, recording, or by any information storage and retrieval system, without the prior written permission of Golden Valley Engineering & Surveying, Inc.

NO.	REVISIONS

GOLDEN VALLEY
ENGINEERING & SURVEYING

405 W. 19th Street • P.O. Box 349 • Merced, CA 95340
Phone (209) 722-3200 • Fax (209) 722-3254

SITE PLAN FOR
EVANGELICAL FREE CHURCH
A.P.N. 007-171-014

CITY OF MERCED CALIFORNIA

PREPARED FOR:
Evangelical Free Church
2876 N. G Street
Merced, CA 95340
Ph. (209) 385-7431
Fax: (209) 725-3536

SHEET CONTAINS:
- SITE PLAN

DESIGNED: G.V.E.A.S.
DRAWN BY: CHRISTINE L.
CHECKED: JK
DATE: Feb. 24, 2005
JOB NO.: 05-008

SHEET
G-1

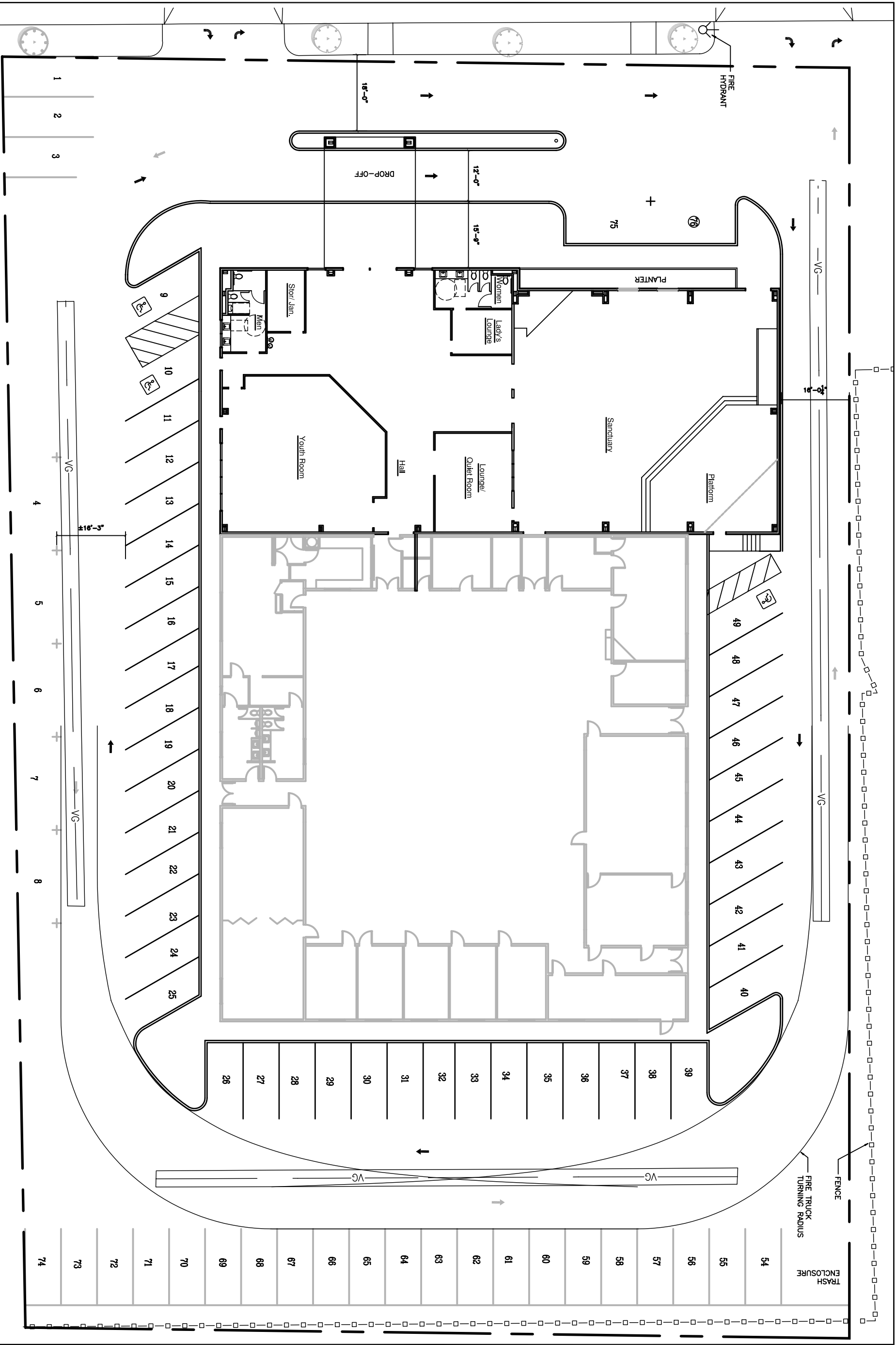

F:\0105-008_Evangelical Free Church\NEW DWG_11-10-05\SITE.dwg, 2/24/2006 5:40:57 PM, Acrobat Distiller

SITE DATA:
A.P.N.: 007-171-014
ADDRESS: 2876 N. G ST.
ZONING: R-1-6
LOT SIZE: 60,340 SQ.FT.
BUILDING SIZE: 19,956 SQ.FT. (COVERED AREA 33%)
PARKING REQUIRED FOR 250 SEATS:
PARKING PROVIDED:
SPRINKLER SYSTEM:
75
76

LEGEND
PROPERTY LINE:
EXISTING:
NEW SITE IMPROVEMENT:
EXISTING TRAFFIC FLOW:
PROPOSED TRAFFIC FLOW:

SITE PLAN
SCALE: 1" = 10'

